

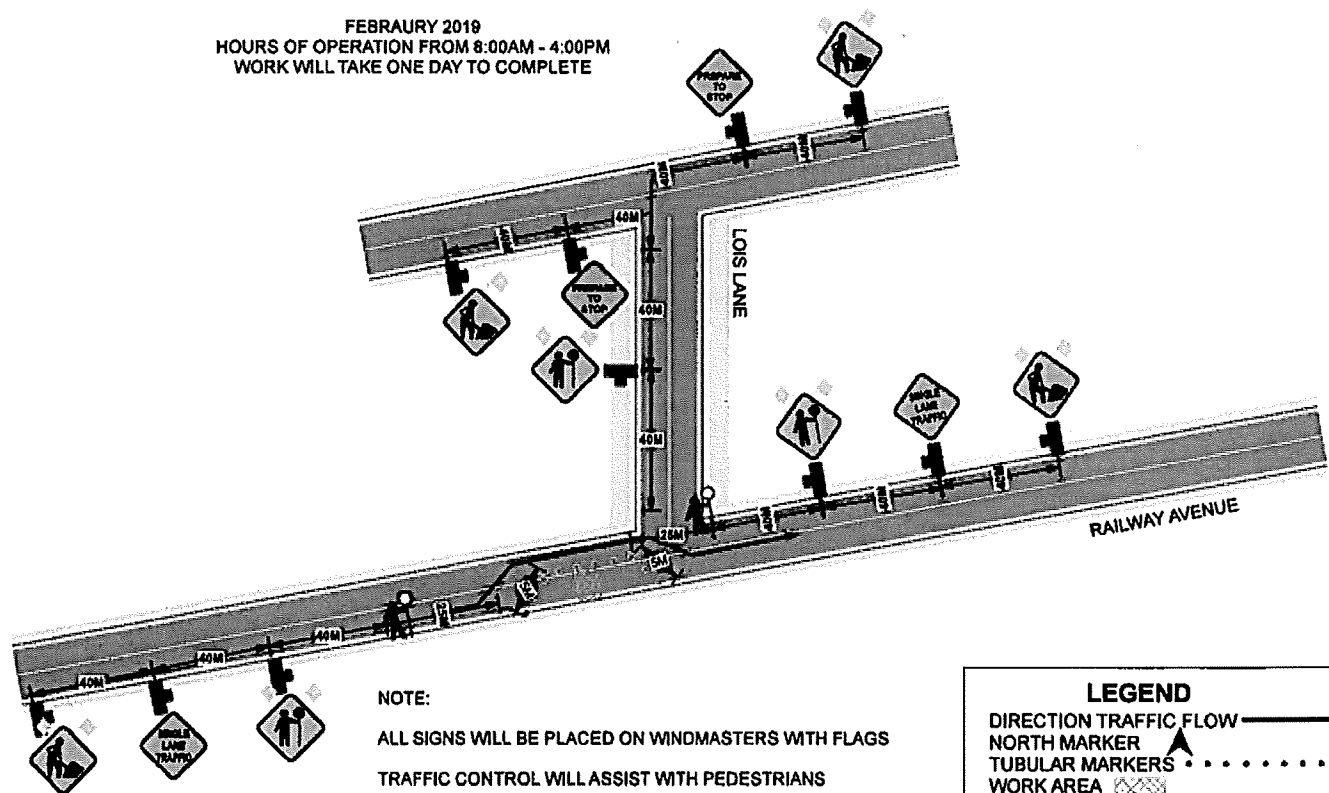

FORTIS BC GAS
VALVE MAINTENANCE
RAILWAY AVENUE - LOIS LANE, CHILLIWACK
JOB# 41282007

FEBRAURY 2019
HOURS OF OPERATION FROM 8:00AM - 4:00PM
WORK WILL TAKE ONE DAY TO COMPLETE



NOTE:

- ALL SIGNS WILL BE PLACED ON WINDMASTERS WITH FLAGS
- TRAFFIC CONTROL WILL ASSIST WITH PEDESTRIANS
- ALL SIDEWALKS - CROSSWALKS - BUS STOPS WILL REMAIN OPEN
- TRAFFIC CONTROL WILL ASSIST WITH DRIVEWAYS EFFECTED BY WORK ZONE CLOSURE

LEGEND

- DIRECTION TRAFFIC FLOW →
- NORTH MARKER ▲
- TUBULAR MARKERS (dotted line)
- WORK AREA [hatched box]
- SIGN STANDS [square with cross]
- TRAFFIC CONTROLLER [stick figure]
- BUS STOP [T symbol]
- FLASHING ARROW BOARD TRUCK [truck with arrow]